

1" DRIVE SOCKETS & ATTACHMENTS



6 Point Deep Length - Impact Black Industrial Finish

Hex Size	6 Point Part No.	Overall Length in. a	Drive End in. b	Hex End in. c	Taper Length in. d	Bolt Clearance in. e	
7/8"	17-628	2.33	2.01	1.54	0.85	0.79	Style I
15/16"	17-630	3.54	2.01	1.57	1.60	0.87	
1"	17-632	3.54	2.01	1.65	1.60	0.91	
1 1/16"	17-634	3.54	2.01	1.73	1.60	0.98	
1 1/8"	17-636	3.54	2.01	1.81	1.60	1.02	
1 3/16"	17-638	3.54	2.01	1.89	1.60	1.1	
1 1/4"	17-640	3.54	2.01	2.01	—	1.18	
1 5/16"	17-642	3.54	2.05	2.09	—	1.22	
1 3/8"	17-644	3.54	2.05	2.13	0.93	1.3	
1 7/16"	17-646	3.54	2.05	2.2	0.94	1.42	
1 1/2"	17-648	3.62	2.05	2.28	1.05	1.42	
1 9/16"	17-650	3.62	2.05	2.36	1.05	1.48	
1 5/8"	17-652	3.62	2.05	2.42	1.08	1.54	
1 11/16"	17-654	3.62	2.05	2.56	1.08	1.61	
1 3/4"	17-656	3.62	2.28	2.6	1.08	1.67	
1 13/16"	17-658	3.62	2.28	2.68	1.08	1.69	
1 7/8"	17-660	3.62	2.28	2.76	1.08	1.75	
1 15/16"	17-662	3.62	2.28	2.83	1.15	1.77	
2"	17-664	3.74	2.28	2.91	1.15	1.81	
2 1/16"	17-666	3.74	2.28	2.95	1.06	1.85	
2 1/8"	17-668	3.94	2.28	3.07	1.06	1.93	
2 3/16"	17-670	3.94	2.44	3.15	1.06	1.99	
2 1/4"	17-672	3.94	2.44	3.31	1.06	2.05	
2 5/16"	17-674	4.13	2.44	3.39	1.08	2.11	
2 3/8"	17-676	4.13	2.44	3.43	1.08	2.17	
2 7/16"	17-678	4.33	2.44	3.5	1.08	2.24	
2 1/2"	17-680	4.33	2.44	3.58	1.08	2.3	
2 9/16"	17-682	4.72	2.44	3.66	1.08	2.36	
2 5/8"	17-684	4.72	2.44	3.74	1.08	2.42	
2 3/4"	17-688	4.88	2.44	3.86	1.20	2.56	
							Style II

6 Point Standard Length - Impact Black Industrial Finish

Hex Size	6 Point Part No.	Overall Length mm a	Drive End mm b	Hex End mm c	Taper Length mm d	Bolt Clearance mm e	
19mm	XP19H	58	51	36	23	17	Style I
22mm	XP22H	58	51	39	23	20	
24mm	XP24H	58	51	40	23	22	
26mm	XP26H	58	51	42.5	23	24	
27mm	XP27H	58	51	44	23	25	
28mm	XP28H	58	51	45	23	26	
29mm	XP29H	60	51	46	25	27	
30mm	XP30H	60	51	48	25	28	
32mm	XP32H	60	51	51	—	30	
33mm	XP33H	62	53	53	—	30	
35mm	XP35H	62	53	54	—	30	
36mm	XP36H	62	53	56	—	32	
38mm	XP38H	62	53	58	—	32	
41mm	XP41H	62	53	61.5	—	37	
46mm	XP46H	64	54	68	—	42	
50mm	XP50H	70	54	73	—	45	
54mm	XP54H	70	54	78	—	50	
55mm	XP55H	72	54	79	—	50	
58mm	XP58H	75	54	84	—	53	
60mm	XP60H	78	54	87	—	55	
65mm	XP65H	80	54	93	—	60	
70mm	XP70H	85	54	98	—	65	
75mm	XP75H	98	86	104	—	70	
80mm	XP80H	100	86	109	—	75	
85mm	XP85H	100	115	86	—	75	
90mm	XP90H	105	125	86	—	80	
95mm	XP95H	105	130	86	—	85	
105mm	XP105H	105	143	95	—	90	
110mm	XP110H	105	147	95	—	95	
115mm	XP115H	105	152	95	—	80	
							Style III

Federal Spec. U.S. GGG-W-660A ANSI Spec. B107.2-1975

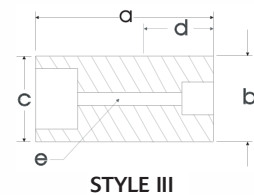
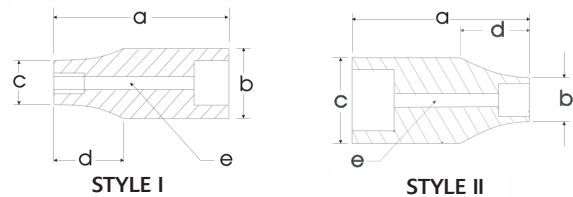

Federal Spec. U.S. GGG-W-660A ANSI Spec. B107.2-1975